

## Manual Reeling System

### TELESCOPIC ROD Installation Instructions

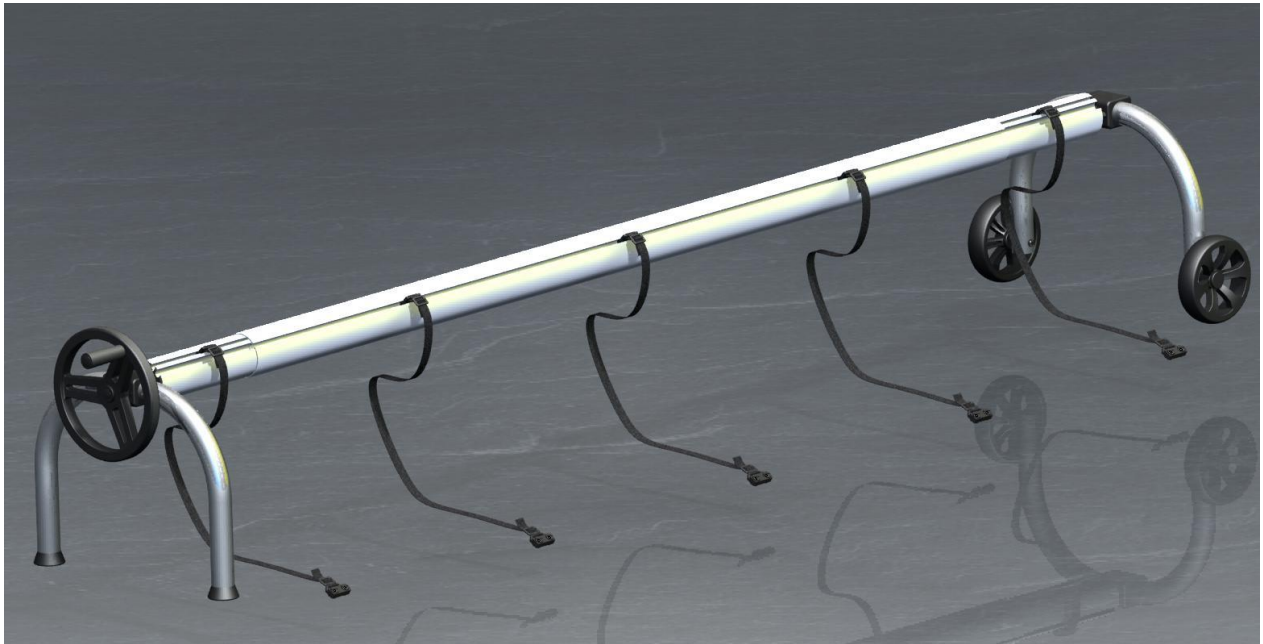

#### **Variants:**

Telescopic rod width **2.7 - 4.4 m**

Telescopic rod width **3.7 - 5.4 m**

Telescopic rod width **5.4 - 7.1 m**

## Intended for use with reeling systems.

The manual reeling system is intended for use with all types of sunken pools. In combination with cover or solar foils, it helps protecting the pool contents against penetration of dirt or birds, rodents, frogs, etc. It also reduces heat losses and pool chemistry from the water to extend the swimming season and to reduce water treatment costs.

## Caution

Extract the telescopic rod evenly only to the maximum length for the specific type. Otherwise the rod may be irreversibly distorted, which results in permanent damage to the device and its incorrect function.

The cover or solar foil area should not exceed 60 m<sup>2</sup>.

## Package contents

See the attached table for the contents of the package. The contents differ according to the width of the telescopic rod of the manual reeling system.

	Width	2.7 - 4.4 m	3.7 - 5.4 m	5.4 - 7.1 m
Pos. no.	Description	Quantity	Quantity	Quantity
1	LARGE REEL DRUM 2,700 mm	1	1	1
2	SMALL REEL DRUM 1,350 mm LEFT+RIGHT	2		
2	SMALL REEL DRUM 1850 mm LEFT+RIGHT		2	
2	SMALL REEL DRUM 2700 mm LEFT+RIGHT			2
3	JOINT	5	7	9
4	FOIL BRACKET 1	5	7	9
5	FOIL BRACKET 2	5	7	9
6	SCREW SS 3.5X13	8	8	8
7	NUT M6	2	2	2
8	SCREW M6X12	2	2	2
9	PLASTIC SCREW M6x16x10	10	14	18
10	PLASTIC NUT M6x16x10	10	14	18
11	STRAP width 20 – length 1,500 mm	5	7	9
12	PLASTIC BUCKLE – FAIRLEAD 20	10	14	18

Assembly diagram

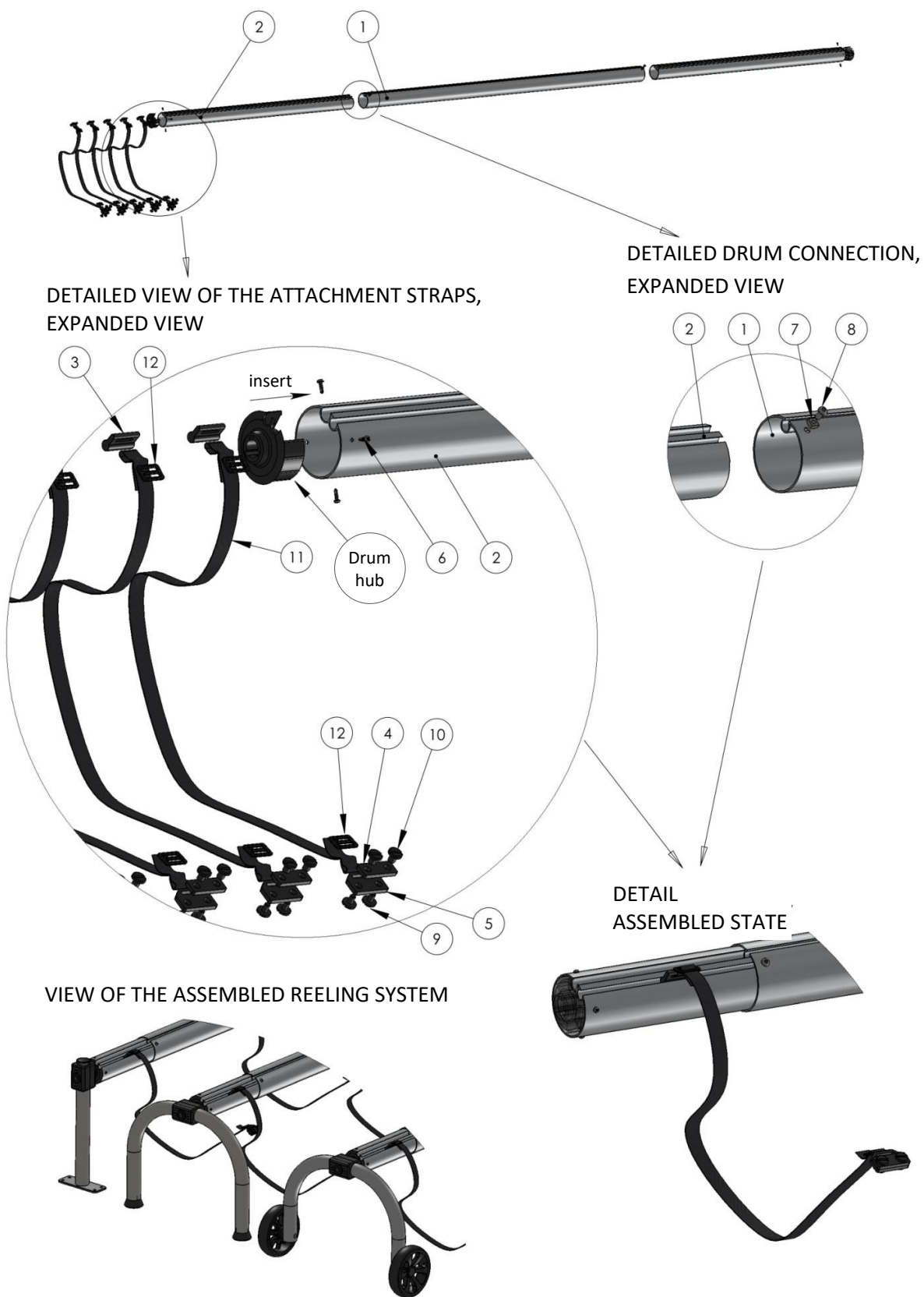

### ASSEMBLY NOTES:

1. Inserting small drums, Pos. 2, into the large drum, Pos. 1, is carried separately without pre-bored holes.
2. Nut, Pos. 7, and screw, Pos. 8, are used to fix the drums after setting the required length.
3. Adjust the required length (according to the water level) of all the straps, Pos. 11, using the buckles, Pos. 12. If the length of the straps is not equal the cover foil will be reeled up unevenly.
4. Distribute the straps evenly over the entire length of the telescopic rod based on the width of the cover or solar foil.
5. Locate the outer straps approx. 3 cm from the edge of the foil.
6. Mount the assembled drum onto the drum hub and attach using 4 screws 3.5 x 13, Pos. 6, on both sides, see the assembly diagram. The drum hub is not included in the telescopic rod package; it is part of the stand package. Mount the drum only after completing the stand assembly.
7. Cut the appropriate solar or cover foil according to the pool dimensions with a sufficient clearance to avoid rubbing the foil against the pool walls during unreeling / reeling. Then attach the foil to the straps.

### REELING SYSTEM LOCATION

The reeling system performs optimally only if it is located above the pool edge, perpendicular to its axis and centered. Only in this case it will follow the optimum direction of the foil reeling / unreeling. If the device is located too far from the pool edge the foil will rub against the pool walls, which causes the premature wear of the foil.

Incorrect location of the reeling system may cause damage both to the pool and the foil used!

### USE, MAINTENANCE AND STORAGE INSTRUCTIONS

This device does not require any special maintenance. Check the technical conditions of the device and tightening of the screw connections on a regular basis. If in case of any deposits of the dirt or the chemical compounds from the pool water on the surface, wash the reeling system with fresh water. All the parts are made of the corrosion resistant materials and do not require any special protection.

After winterizing a pool, we recommend to store the reeling system in a safe, dry place, which is protected against a mechanical damage.

GARSYS s.r.o., the manufacturer, reserves the right to modify the product. Country of origin: Czech Republic